

REZILLCHANNEL™

SPECIALTY HARDWOOD SYSTEM



connorsports.com



CONNOR® SPORTS
Where Champions Play™



CONNOR SPORTS
Where Champions Play™



Agriculture University of Middle China



UNC Carmichael



Baylor University

Heavy duty, wall to wall steel channel construction provides outstanding buckle resistance and dimensional stability with double plywood layer subfloor construction.

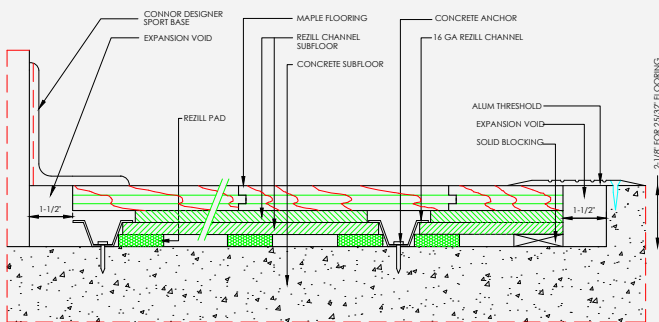

Manufacturing:
ISO 14001:2015



Certified Testing:
ISS Scientific Body
Membership



Recycled Contribution:
Includes components
with recycled content



Green Status:
Managed Forests,
Certification Available



Testing Laboratory:
United States Sports
Surfacing Laboratory

Customer Service: 800.283.9522 | info@connorsports.com | connorsports.com/products

Where Champions Play™

TARAFLEX
— SPORTS FLOORING —

