

# PRO FORMA FLEXWEAVE

CONNOR DANCE STUDIO & STAGE FLOOR SYSTEMS™

Premium Studio Subfloor

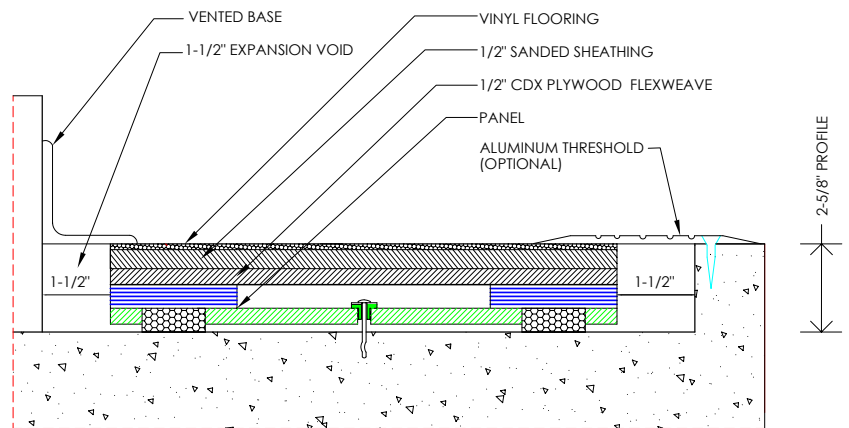



Image courtesy of Wear Moi Dancewear  
Photographer: David Herrero

# PRO FORMA FLEXWEAVE

Connor Dance Subfloor Systems are engineered sprung solutions that balance the safety of the performer with the uniformity and control necessary allowing artists to master their discipline. This sprung basket weave design creates a natural flex response allowing dancers to move with grace and power. Pro Forma Flexweave is designed to match a traditional basketweave system with increased levels of shock absorption and energy restitution. Pro Forma Flexweave is ideal for all dance disciplines looking to perform on a traditional woodsprung dance subfloor. This is best when used as a complete system with Connor Dance Vinyl.



## Product Specifications:

Installation:	Anchored
Shock Absorption (ANSI E2.26):	59%
Rolling Load:	1500N
Vertical Deflection:	4.1
Area Deflection:	8

For optimal safety and performance, install with a Connor Dance Vinyl. For most updated specification, installation, and product detail, visit [connorsports.com/dance](http://connorsports.com/dance).



"The dance floor is the most important element in a dancer's life. If the floor isn't suitable to properly and kindly receive the dancer's weight as she executes her steps and lands from jumps, the daily wear and tear on the body wears heavily over time."

— Benjamin Millepied, L.A. Dance Project

Customer Service:  
1 800 283 9522  
[info@connorsports.com](mailto:info@connorsports.com)  
[connorsports.com/dance](http://connorsports.com/dance)



©2025 Connor® is a registered trademark of Connor Sports.

a company of **Gerflor**