

FOCUS™

PERFORMANCE HARDWOOD SYSTEM

connorsports.com



CONNOR® SPORTS
Where Champions Play™



CONNOR SPORTS
Where Champions Play™

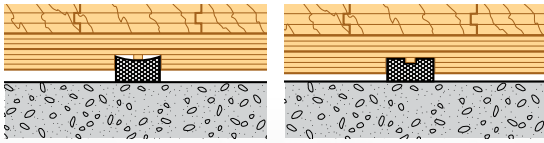

STAGE ONE

Reacting to light athletic loads or individual athletes

STAGE TWO

Reacting to heavy athletic loads or multiple athletes



University of Mississippi



James Madison University

This popular premium performance flooring system featuring our proprietary and patented Athletic Response Ridge™ technology to provide ultra-consistent multi-athlete resilience and comfort.

Can be installed with Secure Grip Technology™ for diverse site challenges and tight schedules.

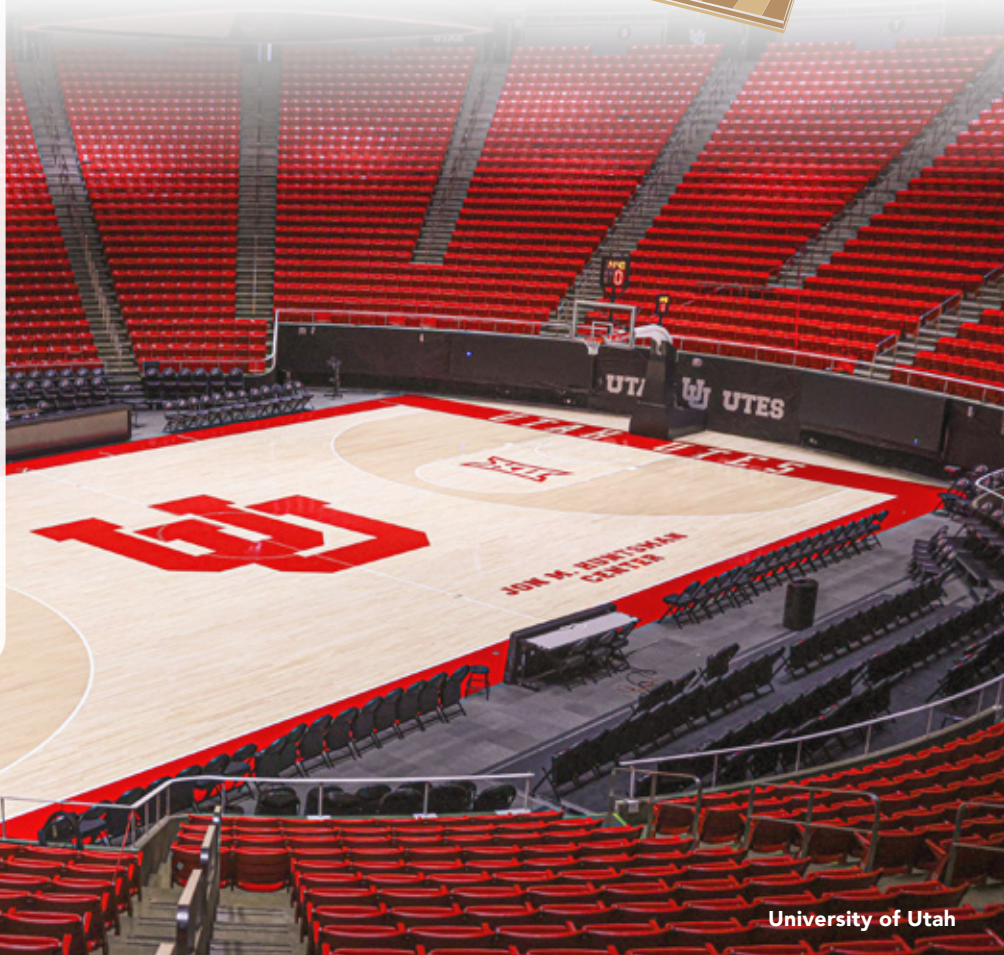

University of Utah

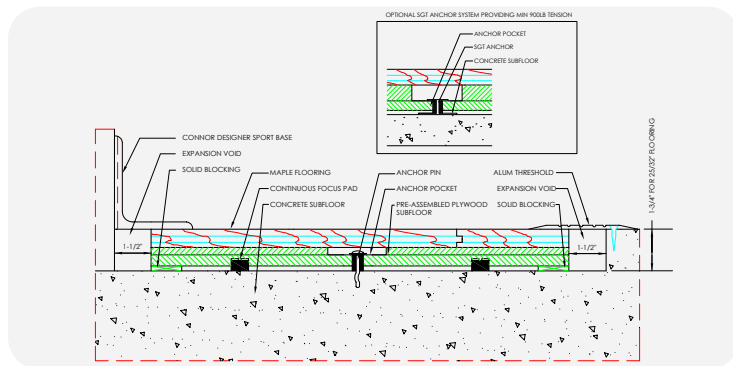

Manufacturing:
ISO 14001:2015



Recycled Contribution:
Includes components with recycled content



Testing Laboratory:
United States Sports Surfacing Laboratory



Certified Testing:
ISS Scientific Body Membership



Green Status:
Managed Forests, Certification Available

Customer Service: 800.283.9522 | info@connorsports.com | connorsports.com/products

Where Champions Play™

TARAFLEX
— SPORTS FLOORING —

