

REDEEM

SPECIALTY HARDWOOD SYSTEM

connorsports.com



CONNOR SPORTS
Where Champions Play™



CONNOR SPORTS
Where Champions Play™



- RedeemM-1 incorporates Eidson F6 padding that is cut to size and stapled directly to the existing sleepers.
- RedeemM-1 subfloor panels are installed on a 45 degree angle in a shi lap configuration.
- Once fully installed, the profile height is comparable to the original flooring system.

REDEEM SPECIALTY HARDWOOD SYSTEM

Redeem provides the option to install a performance based specialty hardwood system by eliminating the cost to remove and dispose of existing sleepers anchored or clipped into the concrete substrate. Saving time and saving money, Redeem gives a retrofit gymnasium installation improved athletic performance and response.

NOTES:

- 1) EIDSON FG STAPLED OVER EXISTING SLEEPERS
- 2) PANELS INSTALLED DIAGONAL TO EXISTING SLEEPER DIRECTION
- 3) PANEL ENDS AND SIDES JOINED VIA SHI LAP
- 4) ANCHOR LOCATIONS TO BE DETERMINED ON SITE
- 5) FLOORING TO BE INSTALLED PERPENDICULAR TO EXISTING SLEEPERS

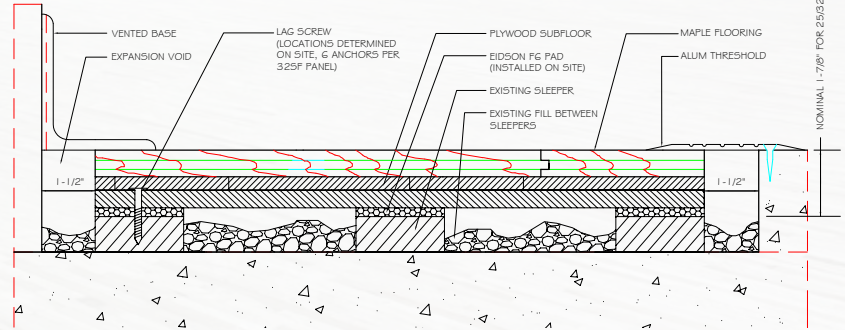

Manufacturing:
ISO 14001:2015



Recycled Contribution:
Includes components with recycled content



Testing Laboratory:
United States Sports Surfacing Laboratory



Certified Testing:
ISS Scientific Body Membership



Green Status:
Managed Forests, Certification Available

Customer Service: 800.283.9522 | info@connorsports.com | connorsports.com/products

Where Champions Play™

TARAFLEX
— SPORTS FLOORING —

