

# REDEEM

SPECIALTY HARDWOOD SYSTEM

[connorsports.com](http://connorsports.com)



**CONNOR SPORTS**  
*Where Champions Play™*





**CONNOR SPORTS**  
Where Champions Play™



- Redeem incorporates Eidson F6 padding that is cut to size and stapled directly to the existing sleepers.
- Redeem subfloor panels are installed on a 45 degree angle in a shiplap configuration.
- Once fully installed, the profile height is comparable to the original flooring system.

# REDEEM

## SPECIALTY HARDWOOD SYSTEM

Redeem provides the option to install a performance based specialty hardwood system by eliminating the cost to remove and dispose of existing sleepers anchored or clipped into the concrete substrate. Saving time and saving money, Redeem gives a retrofit gymnasium installation improved athletic performance and response.

### NOTES:

- 1) EIDSON FG STAPLED OVER EXISTING SLEEPERS
- 2) PANELS INSTALLED DIAGONAL TO EXISTING SLEEPER DIRECTION
- 3) PANEL ENDS AND SIDES JOINED VIA SHIPLAP
- 4) ANCHOR LOCATIONS TO BE DETERMINED ON SITE
- 5) FLOORING TO BE INSTALLED PERPENDICULAR TO EXISTING SLEEPERS

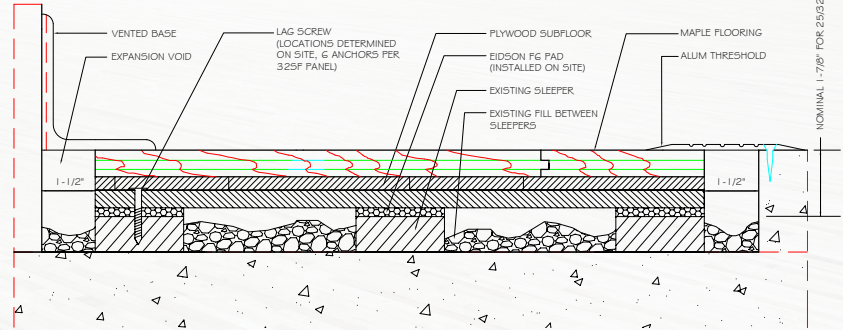

Manufacturing:  
**ISO 14001:2004**  
CERTIFIED



Recycled Contribution:  
Includes components with  
recycled content



Testing Laboratory:  
United States Sports  
Surfacing Laboratory



Certified Testing:  
ISS Scientific Body  
Membership



Green Status:  
Managed Forests,  
Certification Available

Customer Service: 800.283.9522 | [info@connorsports.com](mailto:info@connorsports.com) | [connorsports.com/products](http://connorsports.com/products)

Where Champions Play™

**TARAFLEX**  
— SPORTS FLOORING —

